

Espigueiro

CLOSE TO THE SKY AND THE EARTH

On this side and across the sea, live so many landscapes. In Tourism, the Espigueiro delights visitors from all over the world. As a vacation and weekends home or extra guest bedroom, it is a success. Robust and durable, thanks to ancestral construction techniques, it allows very unique uses. Simple or equipped with bathroom, from the height of one meter twenty, unique sensations are collected. More tranquility, the infinite view and the incredible experience of living at the level of the treetops, thriving with the birds, such wonderful beings.

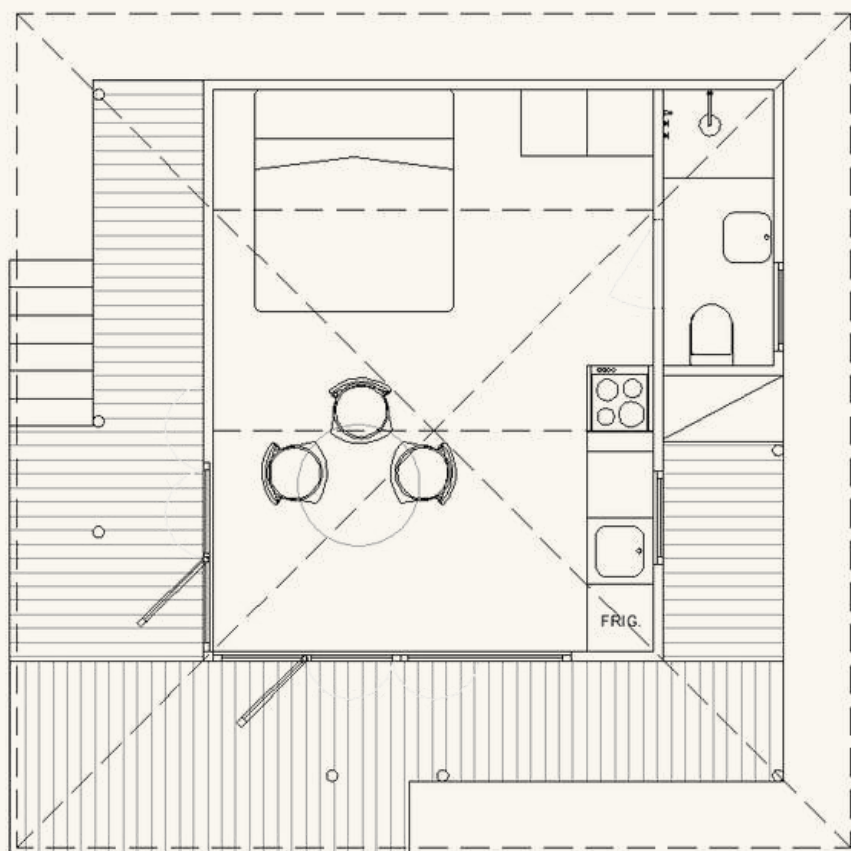

Materials

Structure made from solid Japanese Cedar logs.

Achievement rusticasa®